

5. Exploded View

Indoor Unit

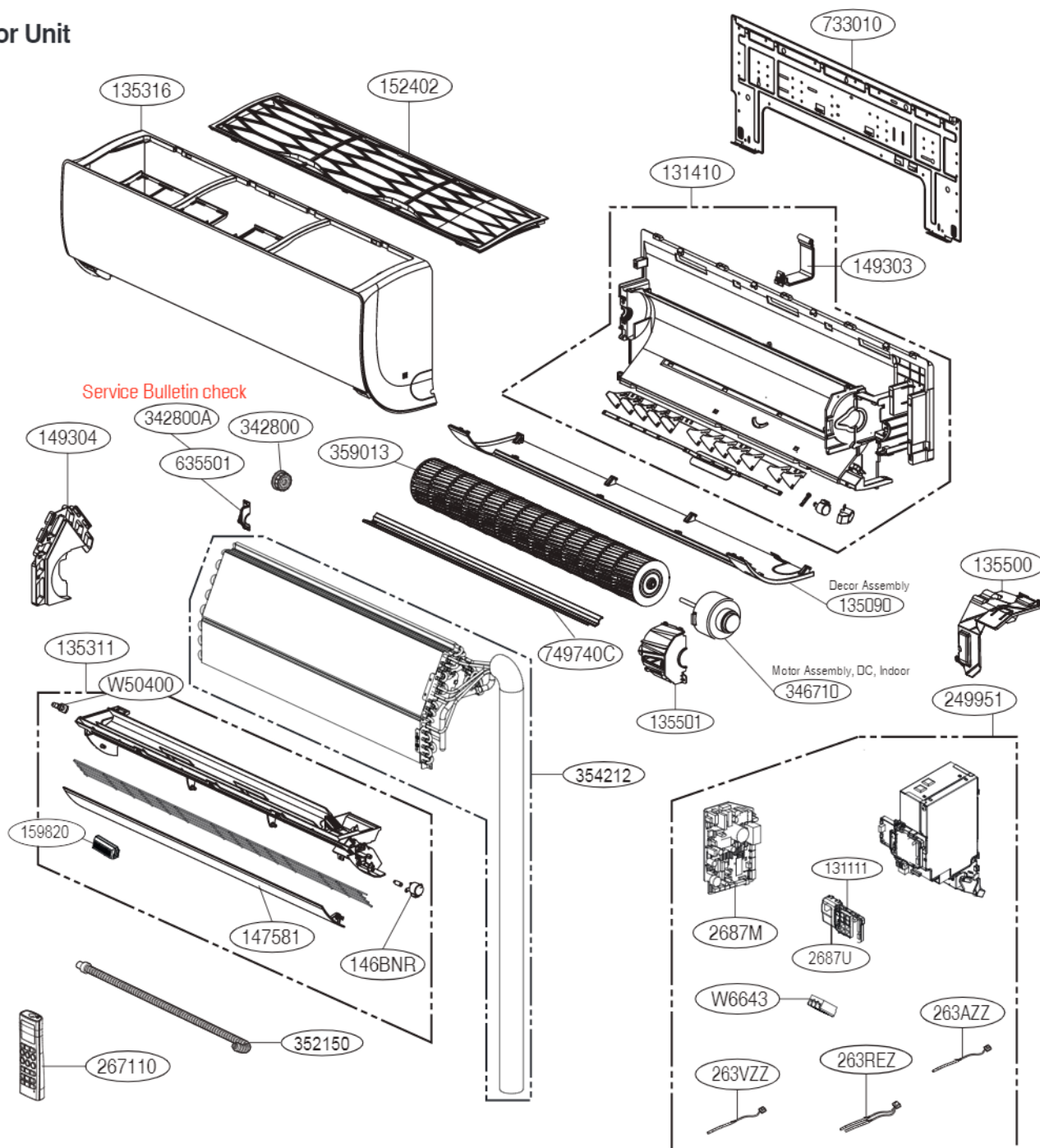

| LOC. | Description | Connector |
|--------|--|-----------|
| 263REZ | Thermistor for indoor air temperature | CN-TH1 |
| | Thermistor for evaporator inlet temperature | |
| 263VZZ | Thermistor for evaporator middle temperature | CN-TH3 |
| 263AZZ | Thermistor for evaporator outlet temperature | CN-TH2 |

Note) * Please ensure GCSC since the replacement parts may be changed depending upon the buyer's request.
Please check the correct parts in View RPL(Replacement Part List) on GCSC.
(GCSC Website <http://www.lge.com>)