

Description	Location No.	Quantity
Condenser Assembly,Bending	554031A	2
Tube Assembly, Manifold(Outdoor)	552115	1
Tube Assembly,Capillary	552111	1
Tube Assembly,Connector	352111	2
Tube Assembly, Return Bending	352119	25

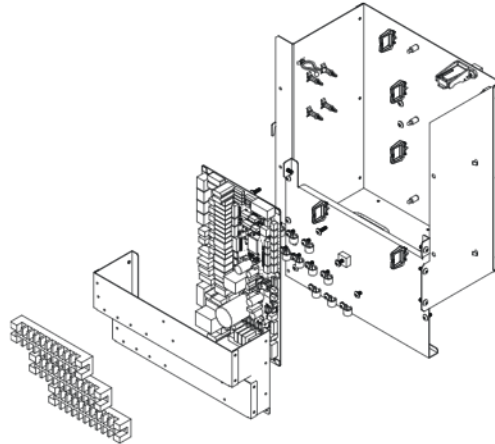

UN60A (1Ø : 9kW)

Control box before structural change (Until August, 2020)



Control box after structural change (From September, 2020)

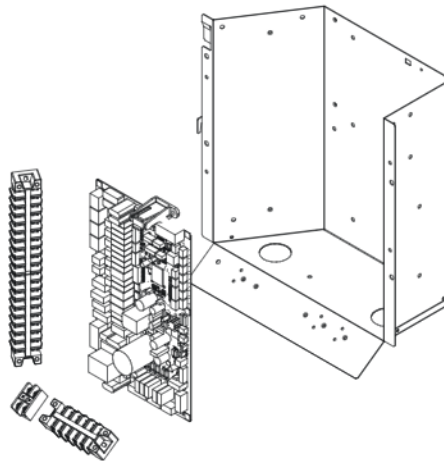

Location No.	Description	Production date	
		Until August. 2020	From September. 2020
249951	Case Assembly, Control(Indoor)	ABQ76661805	ABQ30054402
	Panel Assembly, Control	AGL74237602	-
	Panel,Control	-	MGC66370501
	Bracket Assembly	ABA76828401	-
W6640A	Connector,Terminal Block	3A00093A	-
W6640D	Connector,Terminal Block	-	4G00103A
W6640E	Connector,Terminal Block	-	EAG66728201
W6640F	Connector,Terminal Block	-	EAG38884408

Thermistor Assembly,NTC

Location No.	Thermistor Description	Housing Color
263230A	Water In/Water Out/PHE Out	Black
263230B	Pipe Out	Red
263230C	Pipe In	White
263230D	SUCTION	Green
263230E	DISCHA	Black
263230F	AIR	Yellow
263230G	MID-PIPE	Brown
263230H	CONDENSER_PIPE	Violet
263230J	VI_IN	White

Since Oct. 2nd, 2019, new expansion tank has applied to R32 Monobloc for export.

Location	Description	P/No. (Production date)	
		Until September, 2019	From October, 2019
W4811	Bracket Assembly	ABA74728702	ABA74728703
148382	Tank, Expansion	MJM50027601	MJM63884602

Sound Kit (for purpose of reducing the noise of product in operation)

Location No.	Description	P/No.
W54107A	Insulator,Felt	MEV41280601
W54107B	Insulator,Felt	MEV41280602
W54107C	Insulator,Felt	MEV41280603
W54107D	Insulator,Felt	MEV41280604
W54107E	Insulator,Felt	MEV41280605